

KongressCenter

Kurhaus Bad Homburg v.d.Höhe



- Seminars - Conferences - Banquets - Exhibitions - Events -

Conference Program 2012

How to reach & contact us

Conference Rooms

Conference Room Rates

Technical Equipment

Catering

Service

Fringe Events

How to reach & contact us



HOW TO REACH US

DIRECTIONS & PARKING

By Car:

A5: Exit Bad Homburger Kreuz to A661 Bad Homburg, exit "Bad Homburg Stadtmitte".

A3 from Würzburg: exit Offenbacher Kreuz to A661 Bad Homburg, exit "Bad Homburg Stadtmitte".

A3 from Köln, exit Frankfurter Kreuz to A5 Kassel, exit Bad Homburger Kreuz to A661 Bad Homburg, exit "Bad Homburg Stadtmitte".

Follow signs for "Kurhaus / Kongress".

By train:

-From Frankfurt Central Station take the S5 "Friedrichsdorf". Exit Bad Homburg.

-Or take the U2 Underground from Frankfurt Central Station to Bad Homburg Gonzenheim.

Then take the Citybus direction "Kurhaus".

By plane:

Rhein-Main Airport Frankfurt, from here take the S-Train to Frankfurt Central station. Then follow the instructions "by train" above.

PARKING

Kurhausgarage

343 spaces

Entrance via "Schwedenpfad" or "Ludwigstraße".

Open from 06.00 a.m. until 01.30 a.m.

Schlossgarage

311 spaces

Entrance via "Ritter-von-Marx-Brücke".

Open from 06.00 a.m. until 01.30 a.m.

Rathausgarage

250 spaces

Entrance via "Louisenstraße".

Open from 06.00 a.m. until 01.00 a.m.

Casino-Parkhaus

326 Spaces

Entrance via "Weinbergsweg"

Open all day

Bus parking:

Schwedenpfad (1 space)

Augusta Allee (3 spaces)

Viktoriaweg (3 spaces)

CONTACT:



Office:

Kur- und Kongress-GmbH

KongressService

P.O. Box 18 45

D-61288 Bad Homburg v. d. Höhe

Kurhaus / Louisestraße 58

D-61348 Bad Homburg v. d. Höhe

Delivery address:

Schwedenpfad 1

D-61348 Bad Homburg v. d. Höhe

Telephone: +49 (0) 61 72 / 178 37-30 // -31 // -33 // -34

Telefax +49 (0) 61 72 / 178 37-39

info@kongress-bad-homburg.de

www.kongress-bad-homburg.de

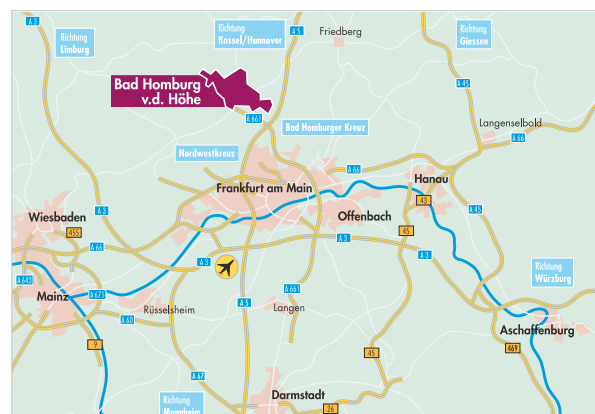

Conference Rooms



Conference Rooms

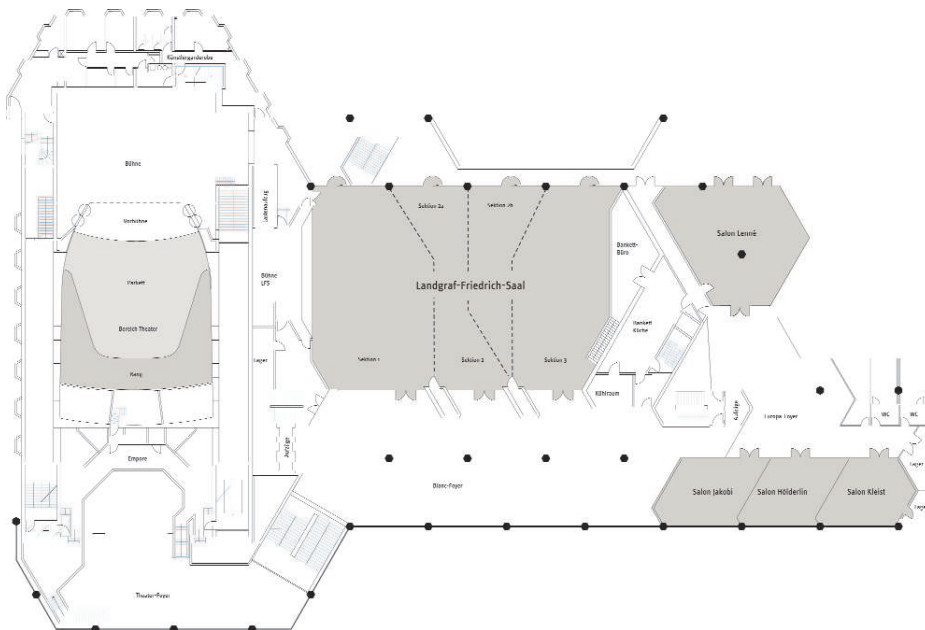

Landgraf-Friedrich Saal I

Air Conditioning:	Yes	Floor area (in sqm)	261	Class room	130
Natural Daylight:	Yes	Height (in m)	6,29 (4,0)	Theater	316
Curtains to darken the room:	Yes	Length (in m)	12,2	Banquet	200
		Width (in m)	21,6	Boardroom	58
		Door dimensions (in m)	1,89 x 1,97	U-Shape	52

Landgraf-Friedrich Saal II

Air Conditioning:	Yes	Floor area (in sqm)	210	Class room	80
Natural Daylight:	Yes	Height (in m)	6,29 (4,0)	Theater	215
Curtains to darken the room:	Yes	Length (in m)	8,3	Banquet	140
		Width (in m)	21,6	Boardroom	44
		Door dimensions (in m)	1,89 x 1,97	U-Shape	40

Landgraf-Friedrich Saal III

Air Conditioning:	Yes	Floor area (in sqm)	236	Class room	110
Natural Daylight:	Yes	Height (in m)	6,29 (4,0)	Theater	292
Curtains to darken the room:	Yes	Length (in m)	12,2	Banquet	200
		Width (in m)	21,6	Boardroom	58
		Door dimensions (in m)	1,89 x 1,97	U-Shape	52

Landgraf-Friedrich-Saal I-III

Air Conditioning:	Yes	Floor area (in sqm)	707	Class room	460
Natural Daylight:	Yes	Height (in m)	6,29 (4,0)	Theater	852
Curtains to darken the room:	Yes	Length (in m)	32,8	Banquet	540
		Width (in m)	21,6	Boardroom	-
		Door dimensions (in m)	1,89 x 1,97	U-Shape	-

Conference Rooms

Landgraf-Friedrich-Saal I-IIa

Air Conditioning:	Yes	Floor area (in sqm)	377	Class room	216
Natural Daylight:	Yes	Height (in m)	6,29 (4,0)	Theater	444
Curtains to darken the room:	Yes	Length (in m)	16,3	Banquet	270
		Width (in m)	21,6	Boardroom	-
		Door dimensions (in m)	1,89 x 1,97	U-Shape	-

Landgraf-Friedrich-Saal IIb-III

Air Conditioning:	Yes	Floor area (in sqm)	325	Class room	171
Natural Daylight:	Yes	Height (in m)	6,29 (4,0)	Theater	360
Curtains to darken the room:	Yes	Length (in m)	16,5	Banquet	270
		Width (in m)	21,6	Boardroom	-
		Door dimensions (in m)	1,89 x 1,97	U-Shape	-

Landgraf-Friedrich-Saal I-II

Air Conditioning:	Yes	Floor area (in sqm)	472	Class room	270
Natural Daylight:	Yes	Height (in m)	6,29 (4,0)	Theater	542
Curtains to darken the room:	Yes	Length (in m)	20,5	Banquet	340
		Width (in m)	21,6	Boardroom	-
		Door dimensions (in m)	1,89 x 1,97	U-Shape	-

Landgraf-Friedrich-Saal II-III

Air Conditioning:	Yes	Floor area (in sqm)	446	Class room	225
Natural Daylight:	Yes	Height (in m)	6,29 (4,0)	Theater	449
Curtains to darken the room:	Yes	Length (in m)	20,6	Banquet	340
		Width (in m)	21,6	Boardroom	-
		Door dimensions (in m)	1,89 x 1,97	U-Shape	-

Blanc-Foyer

Air Conditioning:	Yes	Floor area (in sqm)	514	Class room	-
Natural Daylight:	Yes	Height (in m)	4,4	Theater	-
Curtains to darken the room:	No	Length (in m)	40,5	Banquet	240
		Width (in m)	14,1	Boardroom	-
		Door dimensions (in m)	2,1 x 2,44	U-Shape	-

Salon Lenné

Air Conditioning:	Yes	Floor area (in sqm)	133	Class room	40
Natural Daylight:	Yes	Height (in m)	2,66/3,15	Theater	80
Curtains to darken the room:	Yes	Length (in m)	14	Banquet	120
		Width (in m)	12,6	Boardroom	30
		Door dimensions (in m)	1,89 x 1,97	U-Shape	28

Salon Kleist

Air Conditioning:	Yes	Floor area (in sqm)	57	Class room	20
Natural Daylight:	Yes	Height (in m)	4,4	Theater	50
Curtains to darken the room:	Yes	Length (in m)	8,8 (5,2)	Banquet	30
		Width (in m)	6,88	Boardroom	20
		Door dimensions (in m)	1,89 x 1,97	U-Shape	18

Conference Rooms

Salon Hölderlin

Air Conditioning:	Yes	Floor area (in sqm)	62	Class room	20
Natural Daylight:	Yes	Height (in m)	4,4	Theater	50
Curtains to darken the room:	Yes	Length (in m)	9,25 (8,2)	Banquet	30
		Width (in m)	6,88	Boardroom	20
		Door dimensions (in m)	1,89 x 1,97	U-Shape	18

Salon Jacobi

Air Conditioning:	Yes	Floor area (in sqm)	67	Class room	20
Natural Daylight:	Yes	Height (in m)	4,4	Theater	50
Curtains to darken the room:	Yes	Length (in m)	8,2	Banquet	30
		Width (in m)	6,88	Boardroom	20
		Door dimensions (in m)	1,89 x 1,97	U-Shape	18

Salon Kleist/ Hölderlin/ Jacobi

Air Conditioning:	Yes	Floor area (in sqm)	186	Class room	70
Natural Daylight:	Yes	Height (in m)	4,4	Theater	170
Curtains to darken the room:	Yes	Length (in m)	25,1	Banquet	100
		Width (in m)	6,88	Boardroom	60
		Door dimensions (in m)	1,89 x 1,97	U-Shape	-

Europa-Foyer

Air Conditioning:	Yes	Floor area (in sqm)	-	Class room	-
Natural Daylight:	No	Height (in m)	2,8	Theater	-
Curtains to darken the room:	--	Length (in m)	14,5	Banquet	-
		Width (in m)	16	Boardroom	-
		Door dimensions (in m)	-	U-Shape	-

Theater-Foyer

Air Conditioning:	Yes	Floor area (in sqm)	156	Class room	-
Natural Daylight:	Yes	Height (in m)	2,3/5,5,7,9	Theater	152
Curtains to darken the room:	No	Length (in m)	28,8	Banquet	-
		Width (in m)	10,8/17,6	Boardroom	-
		Door dimensions (in m)	2 x 2,44	U-Shape	-

Kurtheater

Air Conditioning:	Yes	Floor area (in sqm)	-	Class room	-
Natural Daylight:	No	Height (in m)	-	Theater	750
Curtains to darken the room:	--	Length (in m)	23,9	Banquet	-
		Width (in m)	16	Boardroom	-
		Door dimensions (in m)	-	U-Shape	-

External Conference Rooms

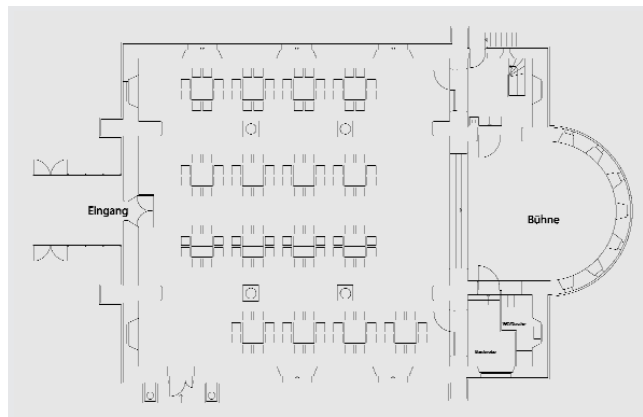

Englische Kirche

Englische Kirche

Ferdinandsplatz, 61348 Bad Homburg v. d. Höhe

Floor:	0	Floor area (in sqm)	310 + Foyer 90	Class room	-
Air Conditioning:	No	Height (in m)	-	Theater	199
Natural Daylight:	Yes	Length (in m)	-	Banquet	128
Curtains to darken the room:	No	Width (in m)	-	Boardroom	-
		Door dimensions (in m)	-	U-Shape	-

Conference Room Rates

Conference Room Rates 2012

Salons	Floor area in sqm	Theater	Class Room	U-Shape	Board-room	Banquet	Rates Half-day in € 6 a.m.- 2 p.m. or 2 p.m. - 12 p.m	Rates Full day in € 6 a.m. – 12 p.m.
Salon Kleist	57	50	20	18	20	30	210,00	305,00
Salon Hölderlin	62	50	20	18	20	30	210,00	305,00
Salon Jacobi	67	50	20	18	20	30	210,00	305,00
Salon Jacobi / Hölderlin	129	100	40	35	40	60	420,00	610,00
Salon Kleist / Hölderlin	119	100	40	35	40	60	420,00	610,00
Salon Kleist / Hölderlin / Jacobi	186	170	70	-	60	100	630,00	910,00
Salon Lenné	133	80	40	28	30	120	455,00	650,00
Landgraf-Friedrich-Saal I	261	316	130	52	58	200	1.290,00	1.840,00
Landgraf-Friedrich-Saal II	210	215	80	40	44	140	795,00	1.140,00
Landgraf-Friedrich-Saal III	236	292	110	52	58	200	795,00	1.140,00
Landgraf-Friedrich-Saal I + IIa	377	444	216	-	-	270	1.690,00	2.410,00
Landgraf-Friedrich-Saal IIb +III	325	360	171	-	-	270	1.190,00	1.705,00
Landgraf-Friedrich-Saal I + II	478	542	270	-	-	340	2.085,00	2.980,00
Landgraf-Friedrich-Saal II + III	446	449	225	-	-	340	1.590,00	2.280,00
Landgraf-Friedrich-Saal I - III	707	852	460	-	-	540	2.880,00	4.115,00
Blanc-Foyer *	514	-	-	-	-	240	-	-
Europa-Foyer **	-	-	-	-	-	-	-	-
Theater-Foyer	156	152	-	-	-	-	635,00	910,00
Theater and Foyer	-	766	-	-	-	-	1.360,00	1.950,00
Dressing Room I	32	-	-	-	-	-	-	85,00
Dressing Room II	32	-	-	-	-	-	-	85,00
Foyer Englische Kirche	90	-	-	-	-	-	-	265,00
Englische Kirche and Foyer	310+90	199	-	-	-	128	680,00	975,00
* Only in combination with Landgraf-Friedrich-Saal .								
** Only in combination with Salons Lenné, Kleist, Hölderlin or Jacobi.								
For exhibitions we charge EUR 16.50 / sqm; minimum the full room rate .								

All rates are subject to change

All rates incl. 19% VAT.

Technical Equipment



No.	Article		Price (brutto) in Euro
11000	Loudspeaker systems, equipment & accessories		
11101	Simple inbuilt loudspeaker system, only two audio-in signals, only in the small salons and single sections of the Landgraf-Friedrich-Saal	per day and room	128,00
11102	Special directional loudspeaker system, only in the small salons and single sections of the Landgraf-Friedrich-Saal	per day and room	180,00
11103	Special directional loudspeaker system, only in combined sections of the Landgraf-Friedrich-Saal	per day and room	280,00
11107	Single audio signal from a laptop to the inbuilt loudspeaker system, e.g. for PowerPoint presentations (no microphones or other signals)	per day and room	77,00
11104	Simultaneous interpretation equipment		on request
11105	Audio signal from a laptop to loudspeaker system (only in combination with No. 11101 to 11103)	per day and unit	20,00
11111	Cape microphone , wireless	per day and unit	71,00
11112	Clip microphone, wireless	per day and unit	71,00
11113	Microphone, wireless	per day and unit	71,00
11114	Microphone	per day and unit	39,00
11115	Headset, wireless	per day and unit	71,00
11116	Microphone with stand	per day and unit	39,00
11201	Piano, incl. tuning	per day and unit	175,20
11202	Grand piano, incl. tuning	per day and unit	336,20
11204	Grand piano, without tuning	per day and unit	242,00
11206	Tuning of piano / grand piano	per day and unit	95,20
11207	Piano, without tuning	per day and unit	80,00
11301	Tape Deck	per day and unit	36,00
11302	Tape / Minidisk	per day and unit	6,00
11304	Minidisk Recorder	per day and unit	47,00
11305	Portable Radio / CD / Cassette-Combination	per day and unit	39,00
11306	DVD-Player	per day and unit	47,00
11307	Digital audio-recording	per day	155,00
11308	DVD or CD for digital recording	per unit	6,00
12000	Lighting & accessories		
12101	Spotlight, mobile	per day and unit	39,00
12103	Follow spot 2000W (without technician)	per day	95,00
12104	Static stage lights	per day	130,00
12105	Floorlight	per day and unit	10,00
12106	8 Floorlights	per day	60,00
12201	Stage & accessories		
12201	Stage platform, 1 x 2 m, variable height from 0.30 to 1.00 m	per day and unit	32,00
12206	Stage platform, 1 x 2 m, variable height from 0.30 to 1.00 m, following day	per day and unit	16,00
12202	Mobile dance floor	per day	on request
12205	Festival tent set (3 parts), max. 1 week	per day and unit	3,50
12301	Forklift (max. 150 KG), without technician	per day	115,00
13000	Personnel		
13101	Temporary staff, on weekdays 7 a.m. - 8 p.m.	per person and hour	22,00
13102	Temporary staff, on weekday after 8 p.m. , Sundays and public holidays	per person and hour	29,00
13201	Security staff, on weekdays 7 a.m. - 8 p.m.	per person and hour	49,00
13202	Security staff, on weekday after 8 p.m. , Sundays and public holidays	per person and hour	55,00
13301	Technician, on weekdays 7 a.m. - 8 p.m.	per person and hour	60,00
13302	Technician, on weekday after 8 p.m. , Sundays and public holidays	per person and hour	74,00
13401	Fire department (3 firemen)	per hour	120,00
13402	Cloakroom attendant, on weekdays 5 a.m. - 10 p.m.	per person and hour	21,00
13403	Cloakroom attendant, other times	per person and hour	41,00
14000	Presentation aids, normal, electronic & accessories		
14102	Display board 1.25 m x 1.00 m or 1.47 m x 1.62 m	per day and unit	26,00
14104	Lectern	per day and unit	0,00
14105	Flipchart, incl. markers and paper	per day and unit	21,00
14106	Pin board, 1.44 m x 1.18 m	per day and unit	20,00
14113	Pin board, 1.44 m x 1.18 m, covered with paper	per day and unit	22,00
14108	PowerPoint Presentation mouse with laser pointer	per day and unit	30,00
14201	Personal Laser Multifunction(Copier, Printer, Scanner, Fax (incl. 500 copies DIN A4)	per day and unit	95,00
14203	"Working Place" (Personal Laser Multifunction + Notebook)	per day and unit	195,00
14202	Further copies DIN A4	per unit	0,15
14204	Overhead projector, 400W	per day and unit	63,00
14205	Overhead projector, 575W	per day and unit	119,00
14206	Notebook	per day and unit	123,00
14223	Beamer XGA, 10.000 AL (only Landgraf-Friedrich-Saal 1)	per day	495,00
14208	Beamer, XGA, min. 4.500 Ansi Lumen	per day	330,00
14211	Beamer, XGA, min. 2.200 Ansi Lumen	per day	230,00
14212	Standard equipment package: Overhead projector (400W), Flipchart and screen 2x2 m	per day and unit	77,00
14209	Laser pointer	per day and unit	16,00

14000	Presentation aids, normal, electronic & accessories		
14213	Facilitator's kit	per day and unit	42,00
14217	VGA distribution box (2 hosts alternating to 1 output)	per day and unit	39,00
14219	VGA data amplifier (1 host to several outputs)	per day and unit	80,00
14218	VGA cable, 10 meters (only if hired on its own)	per day and unit	11,00
15222	TFT-Screen, 19"	per day and unit	65,00
14220	Plasma screen, Blanc-Foyer (between LFS 2 & 3)	per day	65,00
Power supply			
14214	20 each, pad & pen	per set	21,00
14215	50 each, pen & pen	per set	52,00
14216	100 each, pad & pen	per set	103,00
17006	Nameplate A4 folded	per unit	0,50
Power supply			
1700	Power supply 220 V (max. 5 per room)		incl.
17007	Power supply 16 ampere	per unit	125,00
17008	Power supply 32 ampere	per unit	155,00
17009	Power supply 63 ampere, only on the Landgraf-Friedrich-Saal stage	per unit	185,00
Others			
21513	Flags on the "Kurhausvorplatz" 4 flags (subject to availability)	per day	52,00
15000 Telephone & Internet			
15114	DSL line	per connection	59,50
15108	Telephone connection, analog, without terminal	per connection	15,00
15102	Telephone	per day and unit	6,50
15104	Phone unit, national	per unit	0,26
15113	Phone unit, international	per unit	on request
15106	Telefax	per day and unit	36,00
15117	W-Lan package	per connection	119,00
15112	11 Mbps Wireless LAN Card Bus PC Card (plus security)	per day and unit	8,00
16000 Visual Media & accessories			
16102	Slide projector, 250W, Stick	per day and unit	57,00
16202	Screen, 2,5 x 2,5 m	per day and unit	77,00
16203	Screen, 2 x 3 m	per day and unit	128,00
16206	Screen, 3 x 4 m	per day and unit	160,00
16207	Screen, inbuilt Landgraf-Friedrich-Saal, 4 m x 6 m	per day	55,00
16208	Screen 1,8 x 2,3 m	per day and unit	26,00
16301	TV, monitor, 66 cm	per day and unit	62,00
16302	TV, monitor, 91 cm	per day and unit	108,00
16401	Video recorder, VHS	per day and unit	48,00
16402	Video recorder, other standards (NTSC)	per day and unit	58,00
16403	Videocassette, VHS, 180 min	per day and unit	7,50

Catering

Please ask for an individual offer of our Caterer „Huber EventCatering Huber“.

Service

Technical equipment

All conference rooms are equipped with state-of-the-art technical equipment, which is - of course - checked before your event.

Facilitators receive technical instruction. In case of any problems, our staff will be pleased to help.

Stages

The stage in the **Landgraf-Friedrich-Saal** has the following dimensions:

- Floor area: Depth 6 m, Width 14 m (Front of the stage) - 7 m (Back of the stage), Height 5 m

The stage in the **Theater** has the following dimensions:

- Floor area: Depth 10 - 16 m, Width 15 m, Height 18 m
- Proscenium arch: Width 9,80 m, Height 8 m,
- Thrust: Width 13 m, Height 4 m

Accommodation

Bad Homburg offers many excellent hotels. We are happy to help you find accommodation for your guests.

Personnel management

We can arrange additional personnel:

- Security staff
- Secretary service
- Translators
- Limousine service
- Light and sound technicians
- Cloakroom attendants
- Hostesses

Fringe Events

You want to offer your guests special fringe events? Bad Homburg offers a lot of possibilities, e.g. the exclusive Day Spa "Kur-Royal", the thermal bath "Taunus Therme", the casino - the mother of Monte Carlo, culture in the shape of the Kurpark, the Landgrave Castle, the roman fort "Saalburg" or the historic "Hessenpark".